

Dec 5 - 6 - 1910

(70)

Survey for John W. Gibson - in North Baden & in Sec. 30 T7-N R1E

See Field Book C -
pages - 122-123-125-127
for old notes

(Plat Book - p. 54)

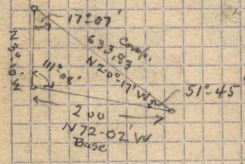
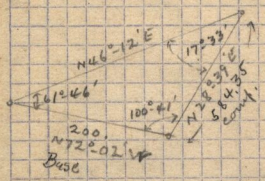

Andrew Clark
S.V. Car.



1/2 Sta. Bridge

M 40° 11' N

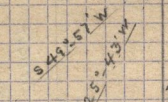

secs. 19-20 (T. 7 N)
29-30 (R. 1 E)

799.97' Sec. line
589.38'

John Gibson
Frame No.



E. Gable

Clark &
Gibson

Plow line

Alfalfa

Mountain
Road

oak stake

County Road

brush land

brush land

Plow land
Gibson & Andrew Clark

Alfalfa

dense brush

Fence

corn field

W 89° 41' W
548.0
connecting
line

stake 12' E. of fence N 45.
cross 544.22' W

N 80° 33' W
200.0

200.6 fence
240.0. cv

South.

1408.6

old fence

1615

N 25° 16' E

N 73° 36' W

S 29° 5' W

S 75° 43' W

577.

N 42° 30' W
577.

S 82° 58' E
604.7

36

15

18

36

17

20

42

17

11

11

11

11

11

11

11

11

11

11

11

11

11